

MEKOS Standing Table



Features:

Toying with tension, the distinguishing feature of the Mekos standing table is the hoop leg form. The curved inner leg and soft lines more reminiscent of residential design, are contrasted with sharp, crisp lines expressed on the outside of the leg. The Mekos standing tables allows employees to change their working position according to task, offering increased connection and easy collaboration.

Options:

- Team tables and small tables
- Omni lid: Rectangular or capsule shape with or without sharknose edge
- Omni duct lite with omni lid

Design: ZENITH DESIGN STUDIO

Warranty: 10 years

Certifications: GECA, AFRDI, Greenguard, Greenguard Gold

Finishes:

Top: One or two-tone 25mm Zenith standard laminates

Omni lid: Zenith standard laminates

Frame: Zenith House powder coat Matt/Satin/
Fine Texture range

Custom colours available upon request

Stocked models and colours may vary

Zenith House Powder Coat:



Cool White
(Satin/
Fine Texture)



Warm White
(Matt)



Cool Grey
(Satin/
Fine Texture)



Gum Grey
(Fine Texture)



Monument
(Matt)



Black
(Satin/ Matt/
Fine Texture)



Chocolate
(Fine Texture)



Burnt Umber
(Fine Texture)



Blush Pink
(Fine Texture)



Rust
(Fine Texture)



Sky Blue
(Fine Texture)



Indigo
(Fine Texture)



Olive
(Fine Texture)

Dimensions

Small Tables

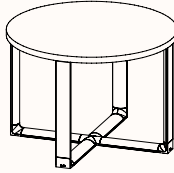
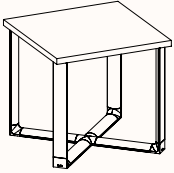
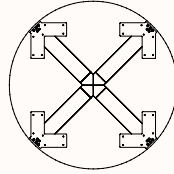
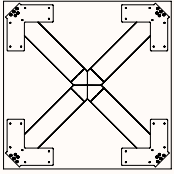

Standing Table MKCS-SQR1

OW 600-1000mm
OD 600-1000mm
OH 750-1050mm

Standing Table MKCS-RND1

DIA 600-1000mm
OH 750-1050mm

*Note: The above tables can achieve other heights, please refer to the other Mekos specifications on the website.

Standing Team Tables

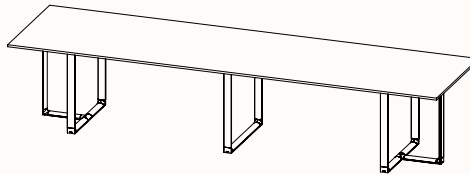
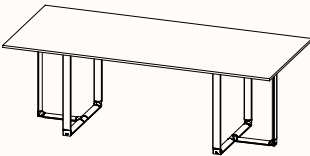
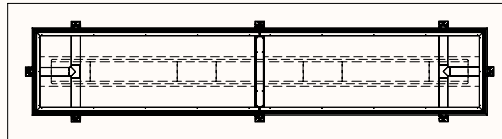
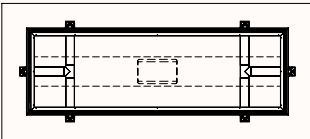

Standing Table MKO-REC2

OW 2000-3200mm
OD 1000-1600mm
OH 900/1050mm

Standing Table MKO-REC3

OW 3200-5200mm
OD 1000-1600mm
OH 900/1050mm

Suitable with 1, 2, 3 or 4 Omni lids depending on table length.
Compatible with Omni duct lite.

Suitable with 2 or 4 Omni lids.
Compatible with Omni duct lite.

Dimensions

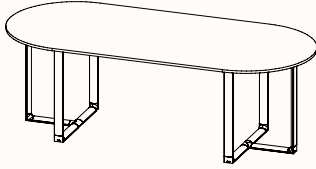
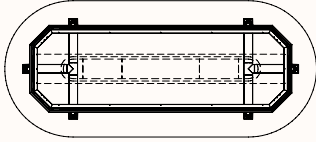

Standing Table MKO-RND2

OW 2400-3200mm
OD 1200-1600mm
OH 900/1050mm

Suitable with 1 or 2 Omni lids depending on table length.

Compatible with Omni duct lite.

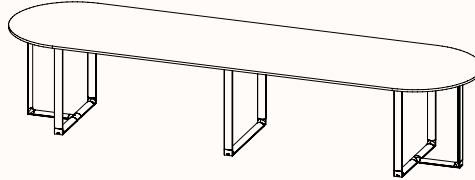
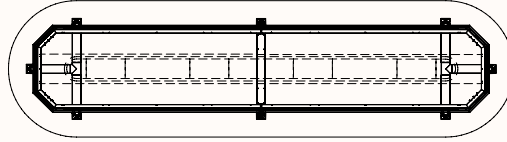

Standing Table MKO-RND3

OW 3200-5200mm
OD 1200-1600mm
OH 900/1050mm

Suitable with 2 or 4 Omni lids.

Compatible with Omni duct lite.

2 -Tone Tops

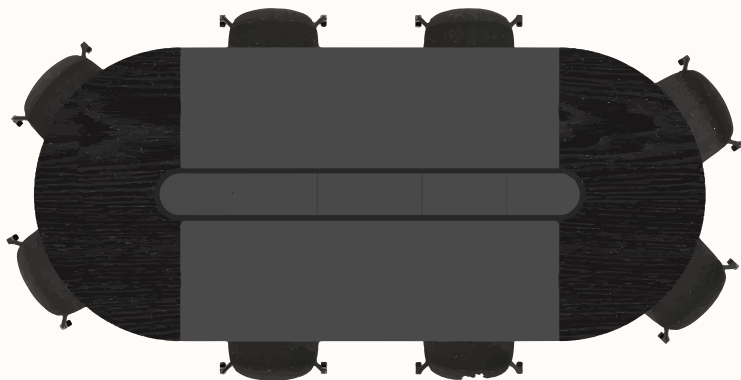

Standing Table

MKO-RND2 | MKO-RND3

Omni Lid finish can match outer top selection

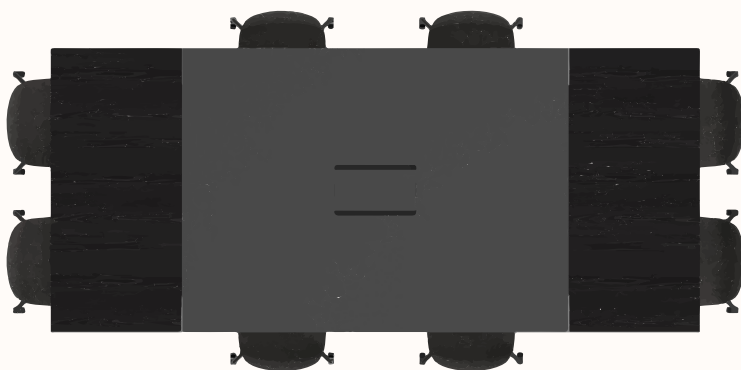

Standing Table

MKO-REC2 | MKO-REC3

Omni Lid finish can match outer top selection

Cable Management

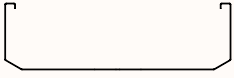

Omni Duct Lite

W 300mm
H 88.5mm

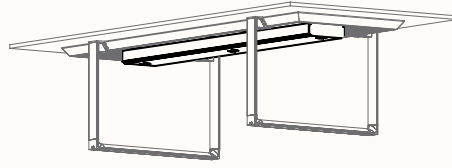

Omni Duct Lite Closed

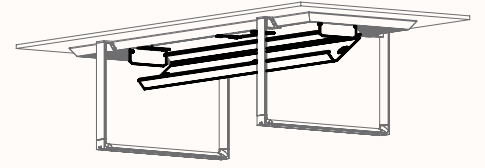

Omni Duct Lite Open

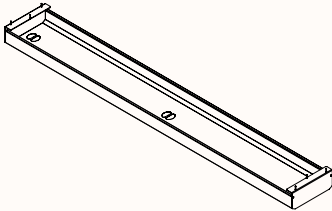

Full length Omni Duct Lite

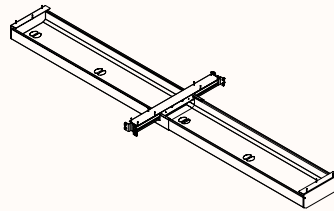

2 piece Omni Duct Lite

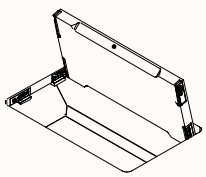

Omni Lid:

Rectangular or Capsule

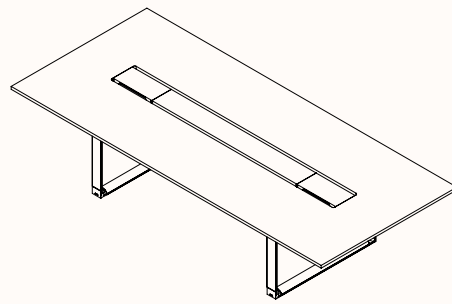

Rectangular Omni Lid

Compatible for tables:

- MKU-REC2/MKU-REC3
- MKO-REC2/MKO-REC3
- MKTM-REC2
- MKC-SQRI/MKC-RND1

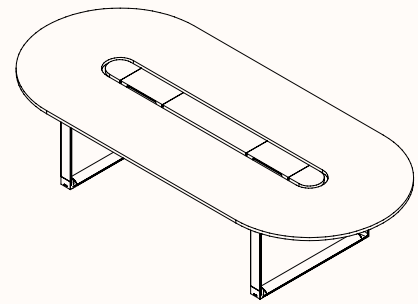

Capsule Omni Lid

Compatible for tables:

- MKU-RND2/MKU-RND3
- MKO-RND2/MKO-RND3