

Zenith

2002
Privacy Booth

2002

2002

2002

Coat Rack/
Storage

←

Bar-B

Verse Plus

By Zenith Design Studio





Discover the endless possibility of Verse Plus

As technology continues to influence where and how we work, the need for agile and adaptive solutions that support unique work modalities is vital. Drawing from a deep understanding of workplace behaviours and organisational trends, Zenith created Verse Plus, a dynamic solution to the acoustic, spatial and environmental needs of the modern workspace.

Verse Plus is an acoustic pod solution that allows you to create new activity-based spaces through combining and adding according to your needs. The "Plus" in Verse Plus is not just a moniker; it denotes endless possibilities: Each 'plus,' offers the potential for new and varied configurations, reimagining and creating new spaces where people can thrive.



Verse Plus is a modular design with standardised panels available in 600mm and 1200mm wall widths. These are the 'building blocks' to creating acoustic areas to fit your organisational requirements.

Each pod can be configured, expanded, or reconfigured, making the design unique and tailored to specific needs. Internal walls can also be created, allowing smaller acoustically separated rooms for focused work or private meetings.

This ensures optimal sound management, making it ideal for bustling offices and open plan areas. The panels can be readily replaced if damaged, making them a resilient solution that can withstand heavy usage in a busy, fast-paced environment.



The fully enclosed air circulation system guarantees optimal ventilation and air quality, providing a comfortable and healthy environment. Power outlet options are also available, allowing ready access for audio visual equipment, media, charging, conferencing a myriad of devices.

Perhaps the most distinguishing feature of Verse Plus is its unique levelling system, ensuring strength and stability. The system offers a standard maximum leveling adjustment of 30mm and a 43mm drop-down seal for acoustic sealing. This guarantees that each room remains perfectly level, regardless of the underlying surface.

3 Green Star for acoustics

Designed to provide exceptional acoustic performance, Verse Plus achieves a high-level privacy rating, and qualifies for Green Star credits for acoustics. Independent acoustic testing shows that normal voice conversations are absorbed between adjoining rooms, ensuring effective sound insulation and privacy within the collaborative workspaces and meeting rooms.

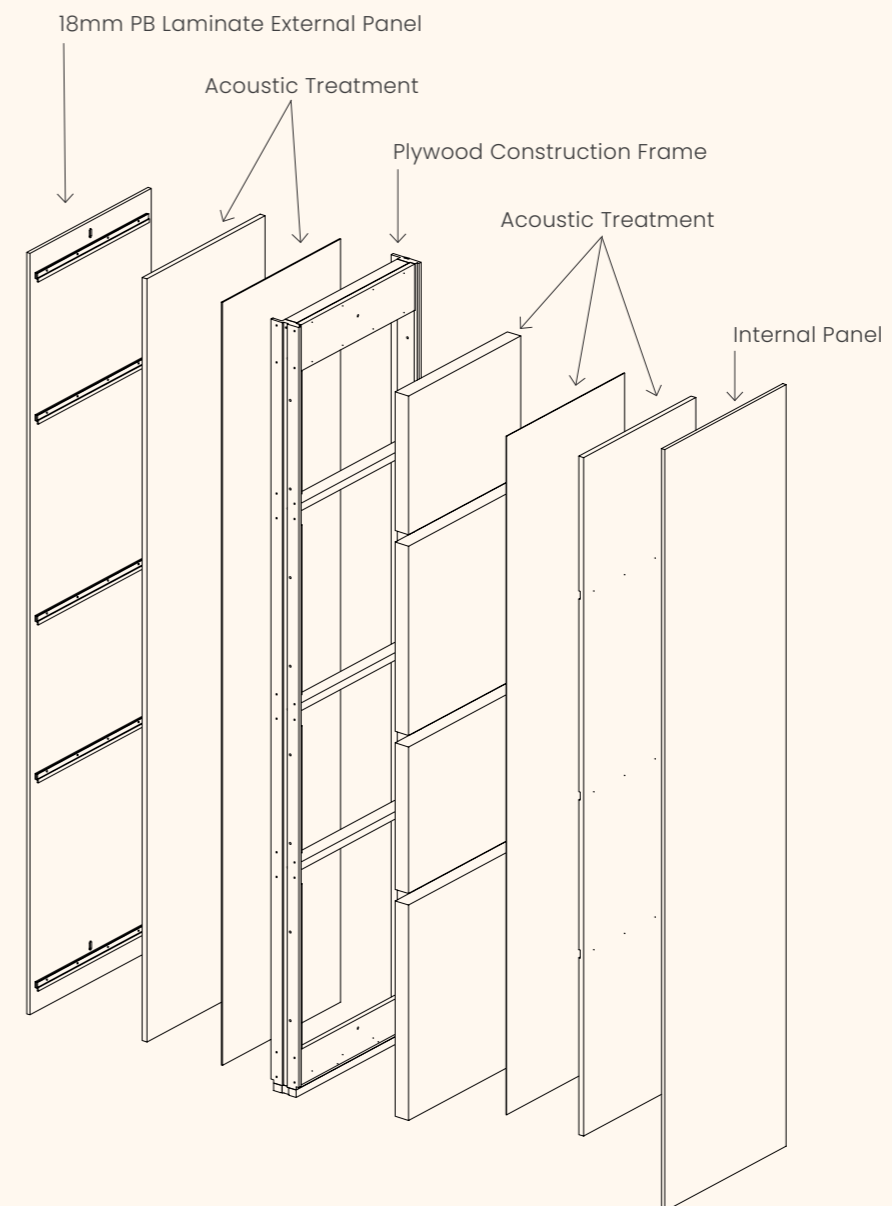



Indicative Configurations - Product is fully configurable to meet your requirements. Other configurations can be customised to suit your requirements

OD 1464mm

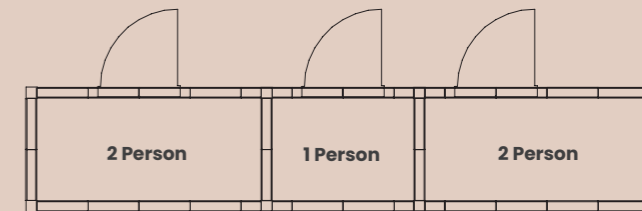
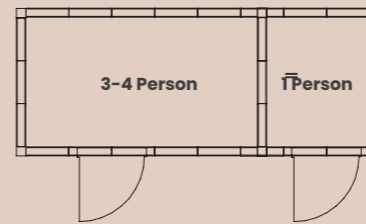
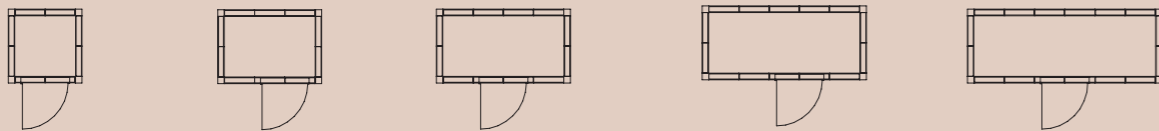

OD 2064mm

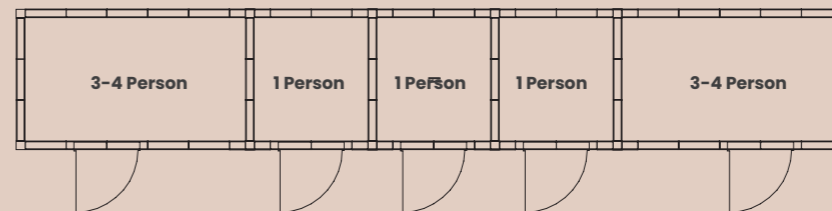
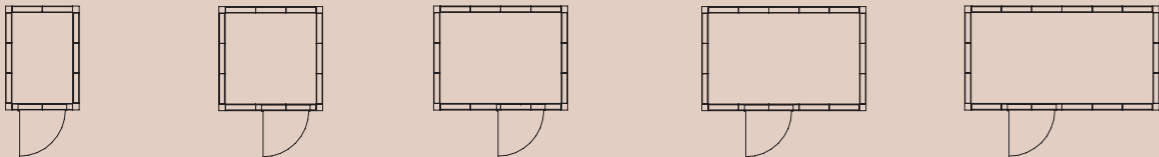

OD 2664mm

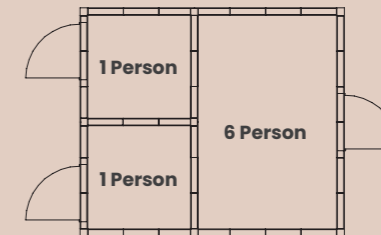
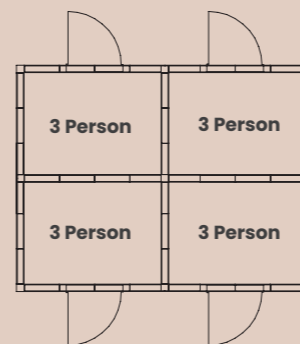
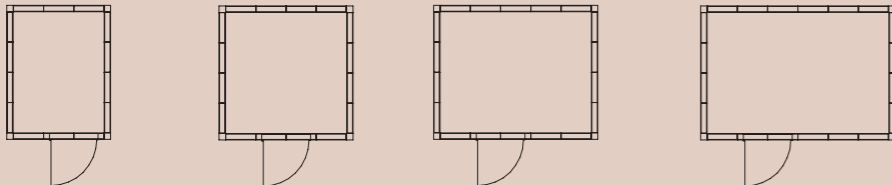

OD 3264mm

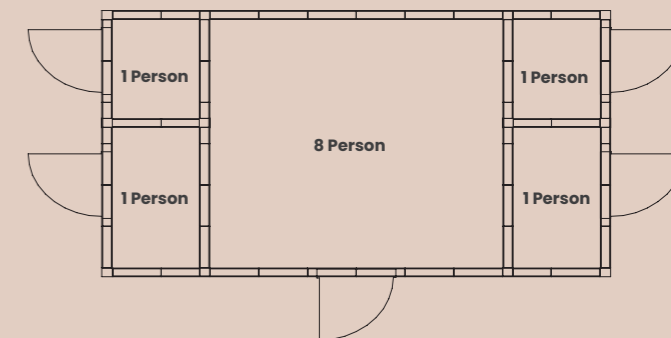
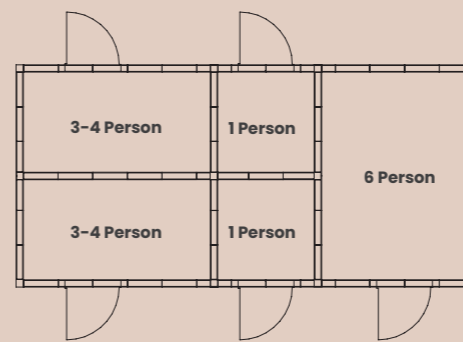
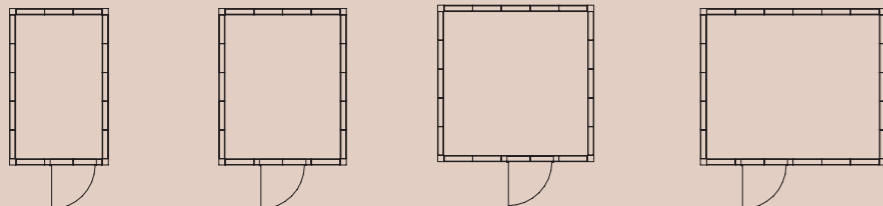

OD 3864mm

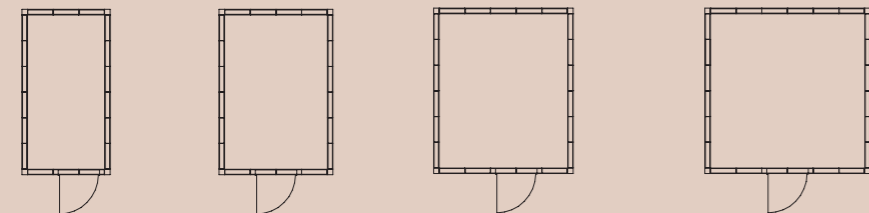

OD 4464mm

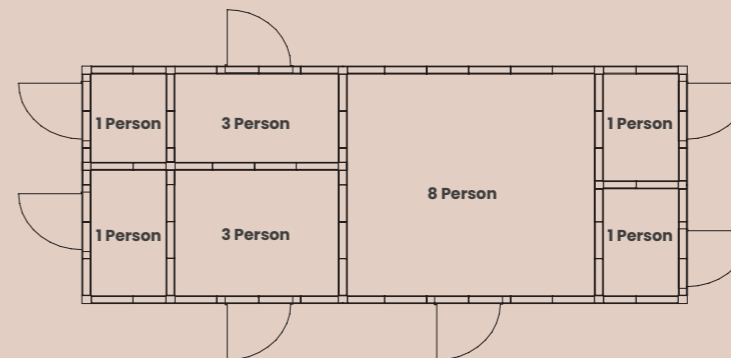
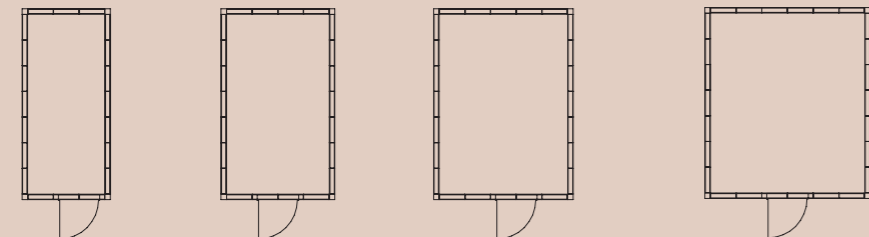

Exploded View (not to Scale)

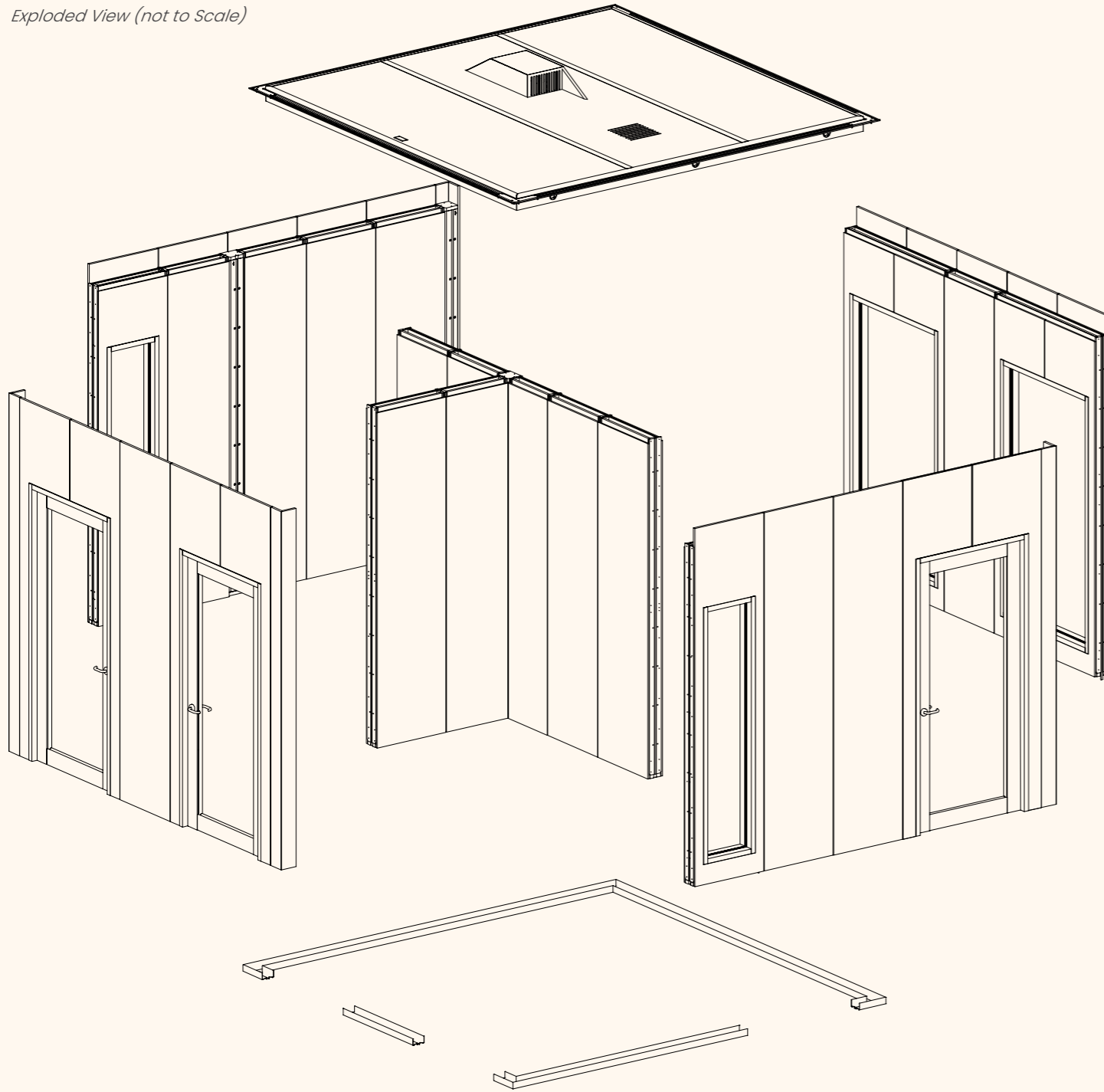

Ease of assembly is a hallmark of Verse Plus. Unlike traditional dry wall systems, these pods are designed for pain free assembly, disassembly and relocation. Whether you're expanding your space or reconfiguring for a new purpose, Verse Plus can evolve with your needs.



100% recyclable at the end of life

True to Zenith's core value of creating sustainable product through vertical integration, all components have been thoughtfully considered for their sustainability at end of life, and all timber used in the Verse Plus frames is ethically sourced. Each acoustic panel can be up to 60% recycled material at the start of life and 100% recyclable at the end of life. Verse Plus has both GECA and Greenguard certification, and its demountable nature ensures minimal material wastage, reducing embodied carbon significantly.





Intergrated booking system

Verse Plus is also compatible with Zenith Connect's 'Rooms' technology; a comprehensive suite of booking software and hardware technology, that offers a rich analytics system to report on room occupancy and drill down on busy periods and occupancy numbers.

Verse Plus can be fitted with PIR sensors and timers to control the fan and light circuit within, meaning it is only powered as required and can be programmed to turn off when not in use. Standard or adjustable lighting settings cater to individual preferences, ensuring the perfect ambiance.



Each pod can be customised with inbuilt joinery and furniture options. Whether you need workstations for quiet focus or a meeting table for collaboration, Verse Plus can be tailored to meet your specific needs, ensuring a perfect fit for any application.

Zenith

Design

Studio

Understanding and collaborating with the client ensures all outcomes are achieved.

Zenith's capacity to research, prototype and test products is an integral part to their design process. By putting an emphasis on researching global trends and anticipating the ever-changing climate of technology in the work environment, Zenith not only responds to demands in the market but pioneers and innovates.

With the capability and facilities to manufacture locally, Zenith products are exceptionally designed, customised and thoroughly tested for product suitability and usability to suit individual needs and user requirements.



Zenith | curators of the modern workspace

We've worked with interior designers, architects and workplace curators for many years. Together, we've developed a range of internal workspace environments. We work alongside these curators of modern workspaces to redefine the environments where people live, work, socialise, interact and learn.

Contemporary workplaces have to combine leading edge technology and physical elements in a way that produces productive environments for organisations. And every organisation is unique. So before we recommend a solution, we work hard to understand the organisation and the people who define its culture.

Our local teams and showrooms deliver the support you need.

Showroom locations

Australia: Melbourne, Sydney, Canberra, Brisbane, Perth, Adelaide

New Zealand: Auckland, Wellington, Christchurch

Asia: Hong Kong, Shanghai, Singapore, Shenzhen

zenithinteriors.com